



Actual View



8/23 Carlisle Street Tamarama NSW

1 1 1

Direct ocean views and a sun-blessed Easterly aspect form the stunning backdrop to this delightful beachside apartment, set above Tamarama Beach and presenting the famed Eastern Suburbs beach lifestyle on a superb platter, complete with parking. Perched on the top floor of a boutique block of just 9, this serene residence is bathed in sun, a radiant living area flowing seamlessly to an E-facing balcony showcasing the shimmering outlook to the surf of Tamarama and ocean beyond. The bedroom is a spacious zone also boasting beach and ocean vistas plus built-in robes, while a chic tiled bathroom features internal laundry. With bright modern kitchen and easy access to parking, this is beachside living at its best. Nestled in a quiet cul-de-sac in one of Sydney's most exclusive coastal hot-spots, it is just minutes to the sand of Tamarama Beach whilst also a quick trip to buzzing M-Deli café and the eateries and bars of Bondi Rd. A lifestyle abode par

Price : Auction | Ian Wallace 0416 251 073
View : <https://www.rwbb.com.au/sale/nsw/eastern-suburbs/tamarama/residential/apartment/8080278>



Ian Wallace
02 8362 4000



Karen Hendry
02 8362 4000



R&W

Bondi Beach

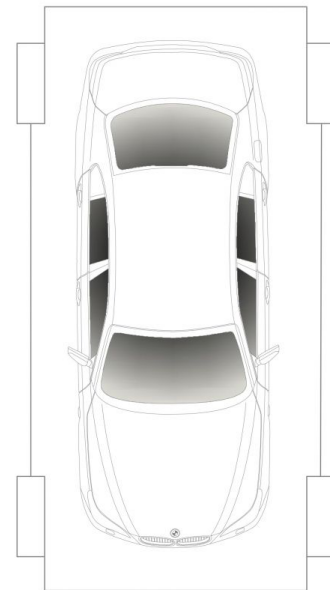
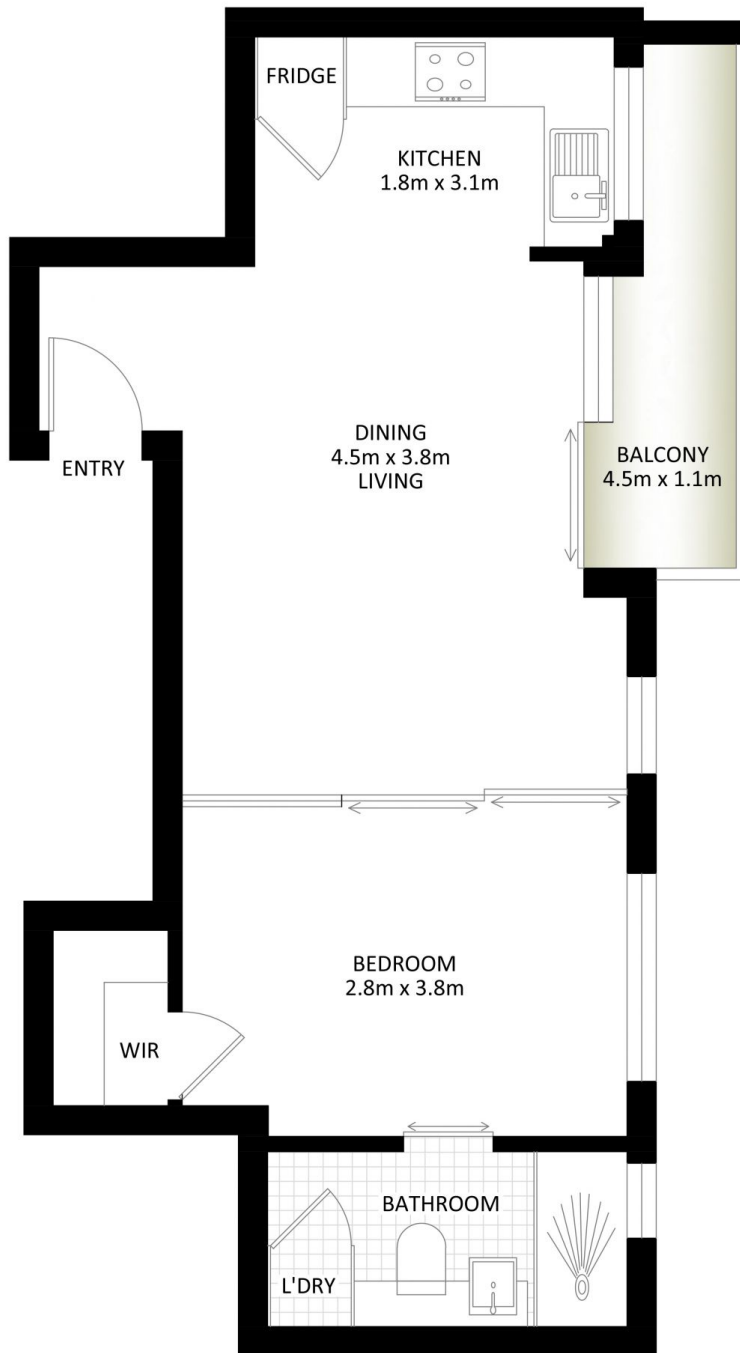

COVERED CARSPACE
5.0m x 2.3m
(NOT ACTUAL LOCATION)

8/23 Carlisle Street, Tamarama



*PLANS SHOWN ONLY INDICATIVE OF LAYOUT. DIMENSIONS ARE APPROXIMATE.

Measurements are approximate and not to scale. The vendor, agency and supplier will accept no liability for its accuracy. Interested parties are advised to make their own independent enquiries.